

ROOF SANDWICH PANELS ALAMENTTI MW_D



SANDWICH ROOF PANEL WITH EXTERNAL AND INTERNAL FACING MADE OF STEEL SHEET. MINERAL WOOL CORE, $\Lambda=0,038$, ANY THICKNESS. EASY TO INSTALL

BASIC PARAMETERS OF THE PANEL

Application	Roof sandwich panel								
Core thickness	Mineral wool MW thickness 105kg/m ³ (± 15%)								
Nominal thickness [cm]	80/115	100/135	120/155	150/185	160/195	180/215	200/235	220/255	250/285
Uc [W/(m ² K)]	0,44	0,36	0,3	0,24	0,23	0,2	0,18	0,17	0,15
Weight [kg/m ²]	19,07	23,27	23,27	26,42	27,47	29,57	31,67	33,77	36,92
Modular width [mm]	1000 mm								
Maximum production length [m]	12,5 m								
Recommended length [m]	Color groups					I – very light colors			9
						II – light colors			6,5
						III – dark colors			6,5
Material for facing	External Facing				Galvanized steel / stainless steel				
	Internal Facing				Galvanized steel / stainless steel				
Type of profiling	External Facing				D_TR trapez				
	Internal Facing				GL gładkie				
					RO rowek				
				LA liniówka					
Standard colors [RAL]	External Facing				1015, 3000, 5003, 6011, 7016, 7024, 8017, 9002, 9006, 9007, 9010, 7016 matt, wood-like ¹				
	Internal Facing				1015, 3000, 5003, 6011, 7016, 7024, 8017, 9002, 9006, 9007, 9010, 7016 matt, wood-like ¹¹				
Fire resistance	NDP	REI 60, RE90					REI 120		

1. Colors – according to the RAL palette;

ROOF SANDWICH PANELS ALAMENTTI MW_D

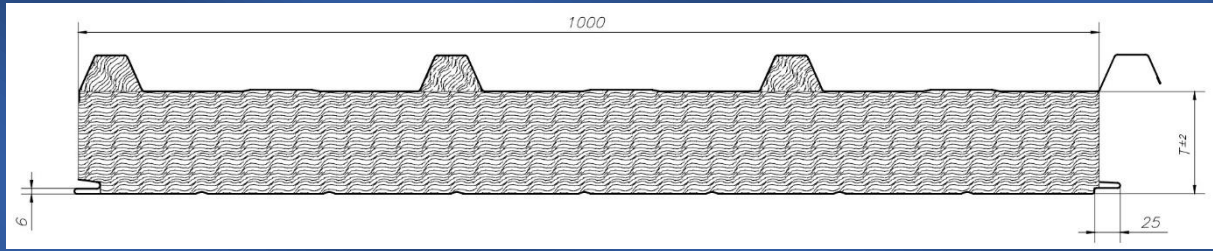

TYPE OF EXTERNAL PROFILING

D_TR – trapez

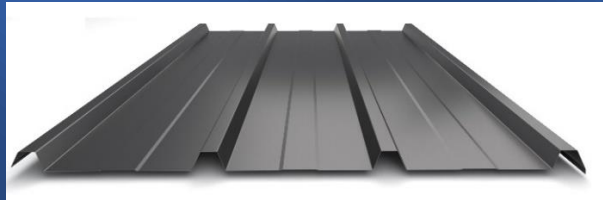

TYPE OF INTERNAL PROFILING

GL – gładkie



RO – rowek



LA - liniówka

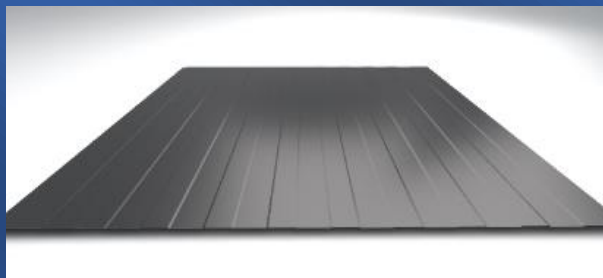

ROOF SANDWICH PANELS ALAMENTTI MW_D

DRAWING. 1. FIXING THE ALAMENTTI D ROOF PANEL TO THE SUPPORT STRUCTURE

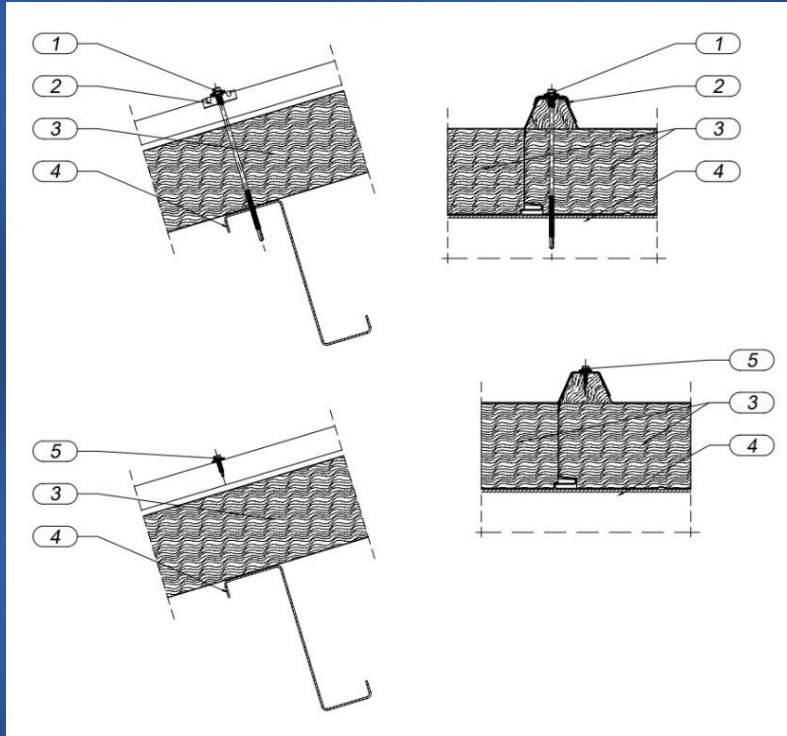

1. Self-drilling screw - self-tapping;
2. Kalota;
3. Roof sandwich panel ALAMENTTI D;
4. Steel profile of the supporting structure;
(according to the Technical Design);
5. Self-drilling screw.